

Securing the work area - TBT 109

What Happened:

Subscan on an active retail site required the site to be closed temporarily. Vehicles and cones were used (See Traffic Management Plan below).

Is this a "robust" Traffic Management Plan?

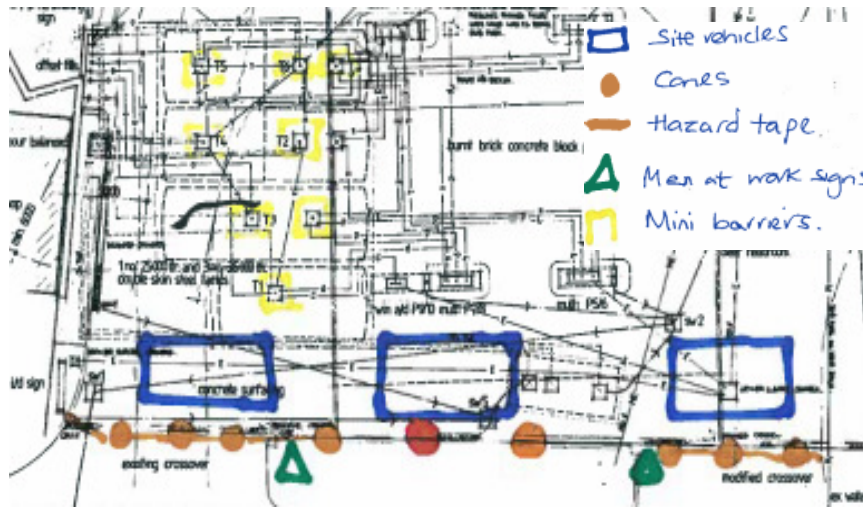

This is what happened;

A driver approached the service station and gained entry to site by driving over the pavement and kerb, in between cones and engineers vehicle. (See Photo)



What could have been done differently?

If the whole site is the work area - Barrier off forecourt using a physical barrier
Use signage to close service station and inform the public (not just men at work)

Securing the work area is everyone's responsibility. Use SPSA to review your work area before you start and as your work proceeds.